

DIS. COD. 36.9501.00

CONTROLSET W1

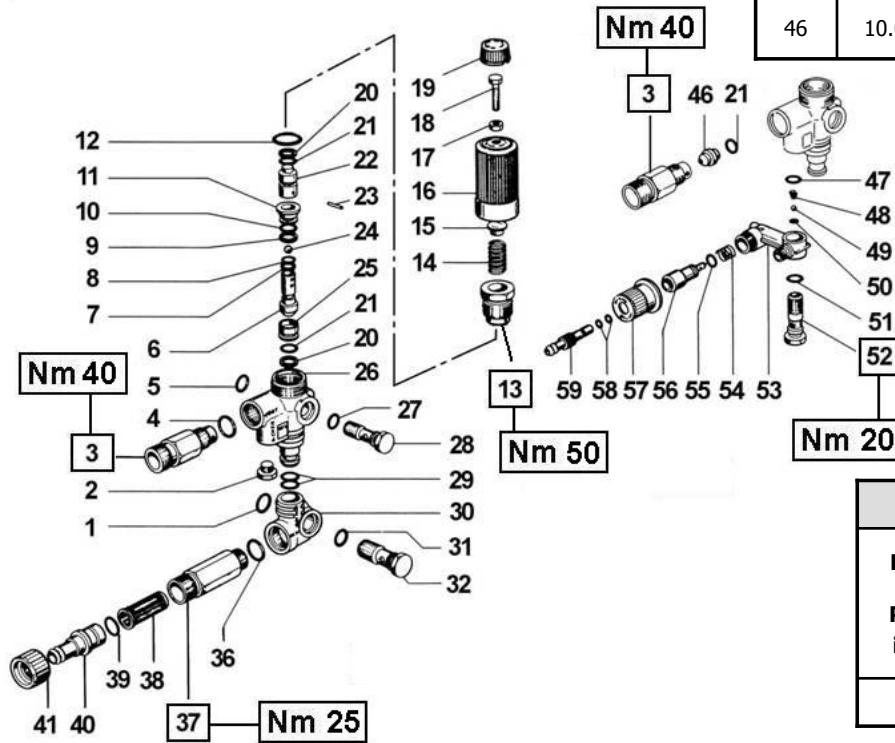

| POS | COD. | DESCRIZIONE - DESCRIPTION | NR |
|-----|------------|--|----|
| 46 | 10.0151.66 | Type 0 - (8÷11 l/min.) Ugello - Nozzle Ø 2 | 1 |
| 46 | 10.0076.66 | Type 1 - (12÷15 l/min.) Ugello - Nozzle Ø 2.2 | 1 |

KIT RICAMBI - SPARE KITS

| KIT NR. | KIT 94 | KIT 98 |
|---|---|--|
| Posizioni incluse Positions included | 4 - 21 - 47 48 - 49 - 50 51 - 54 - 55 58 | 6 - 7 - 8 - 9 10 - 11 - 12 13 - 20 - 21 22 - 23 - 24 25 |
| Nr. Pcs. | 1 | 1 |

DISTINTA - SPARE PARTS

| POS | COD. | DESCRIZIONE - DESCRIPTION KIT | NR |
|-----|------------|------------------------------------|------|
| 1 | 90.3839.00 | OR Ø 15.88x2.62 (121) | 1 |
| 2 | 98.2057.00 | Tappo M14x1.5 | 1 |
| 3 | 10.0147.70 | Nipplo M22x1.5 con Ø 3 | 1 |
| | 10.0078.70 | Nipplo G 3/8" con Ø 3 | 1 |
| | 10.0318.70 | Nipplo G 3/8" NPT con Ø 3 - Vs USA | 1 |
| 4 | 90.3832.00 | OR Ø 13.95x2.62 (3056) | 94 1 |
| 5 | 90.3833.00 | OR Ø 13.95x2.62 (3056) | 1 |
| 6 | 36.3167.66 | Valvola | 98 1 |
| 7 | 90.5025.00 | Anello antiest. Ø 7x10x1.5 | 98 1 |
| 8 | 90.3575.00 | OR Ø 6.75x1.78 (106) | 98 1 |
| 9 | 90.5075.00 | Anello antiest. Ø 13x16x1.5 | 98 1 |
| 10 | 90.3589.00 | OR Ø 12.42x1.78 (2050) | 98 1 |
| 11 | 36.3165.70 | Guida valvola | 98 1 |
| 12 | 90.3847.00 | OR Ø 20.24x2.62 (3081) | 98 1 |
| 13 | 36.3166.70 | Boccola di guida | 98 1 |
| 14 | 94.7436.00 | Molla Ø 15x35 | 1 |
| 15 | 36.3169.70 | Piattello molla | 1 |
| 16 | 36.3171.02 | Pomolo | 1 |
| 17 | 92.2200.00 | Dado M8x5x13 UNI 5589 | 1 |
| 18 | 99.3052.00 | Vite M8x20 | 1 |
| 19 | 36.3172.51 | Cappellotto | 1 |
| 20 | 90.5065.00 | Anello antiest. Ø 10.6x15x2 | 98 2 |
| 21 | 90.3822.00 | OR Ø 9.92x2.62 (112) | 98 3 |
| 22 | 36.3168.66 | Pistoncino di comando | 98 1 |
| 23 | 97.6132.00 | Spina Ø 3x14.5 | 98 1 |
| 24 | 97.4800.00 | Sfera Ø 9/32" | 98 1 |
| 25 | 36.3164.66 | Sede valvola | 98 1 |
| 26 | 36.3163.01 | Corpo valvola | 1 |

| POS | COD. | DESCRIZIONE - DESCRIPTION KIT | NR |
|-----|------------|-----------------------------------|------|
| 27 | 90.3820.00 | OR Ø 9.13x2.62 (109) | 1 |
| 28 | 36.2567.70 | Vite di fissaggio valvola G 1/4" | 1 |
| 29 | 90.3825.00 | OR Ø 10.78x2.62 (3043) | 2 |
| 30 | 36.3152.22 | Raccordo aspirazione | 1 |
| 31 | 90.3827.00 | OR Ø 11.91x2.62 (115) | 1 |
| 32 | 36.2568.70 | Vite di fissaggio valvola G 3/8" | 1 |
| 36 | 90.3591.00 | OR Ø 14x1.78 (2056) | 1 |
| 37 | 36.2560.70 | Nipplo aspiraz. M22x1.5 | 1 |
| | 36.2584.70 | Nipplo aspiraz. 1/2" NPT - Vs USA | 1 |
| 38 | 92.8925.00 | Filtro Ø 12x35 | 1 |
| 39 | 90.3828.00 | OR Ø 12.37x2.62 (3050) | 1 |
| 40 | 36.2569.70 | Portagomma aspirazione | 1 |
| 41 | 10.0119.02 | Ghiera | 1 |
| 46 | *** | Vedi tabella A - See table A | - |
| 47 | 90.3582.00 | OR Ø 9.25x1.78 (2037) | 94 1 |
| 48 | 94.8217.00 | Molla conica Ø 4.3/7.3x11 | 94 1 |
| 49 | 97.4782.00 | Sfera Ø 7/32" | 94 1 |
| 50 | 90.3572.00 | OR Ø 5.28x1.78 (2021) | 94 1 |
| 51 | 90.3585.00 | OR Ø 10.82x1.78 (2043) | 94 1 |
| 52 | 36.2563.70 | Sede valvola | 1 |
| 53 | 36.2562.51 | Corpo dosatore | 1 |
| 54 | 94.7383.00 | Molla Ø 9.75x10 | 94 1 |
| 55 | 90.3580.00 | OR Ø 8.73x1.78 (108) | 94 1 |
| 56 | 36.2564.70 | Otturatore | 1 |
| 57 | 36.2565.51 | Pomolo | 1 |
| 58 | 90.3570.00 | OR Ø 4.48x1.78 (2018) | 94 2 |
| 59 | 36.2566.70 | Innesto portagomma | 1 |