

SERIE 47

Nm 20

Nm 10

Nm 12

Nm 130

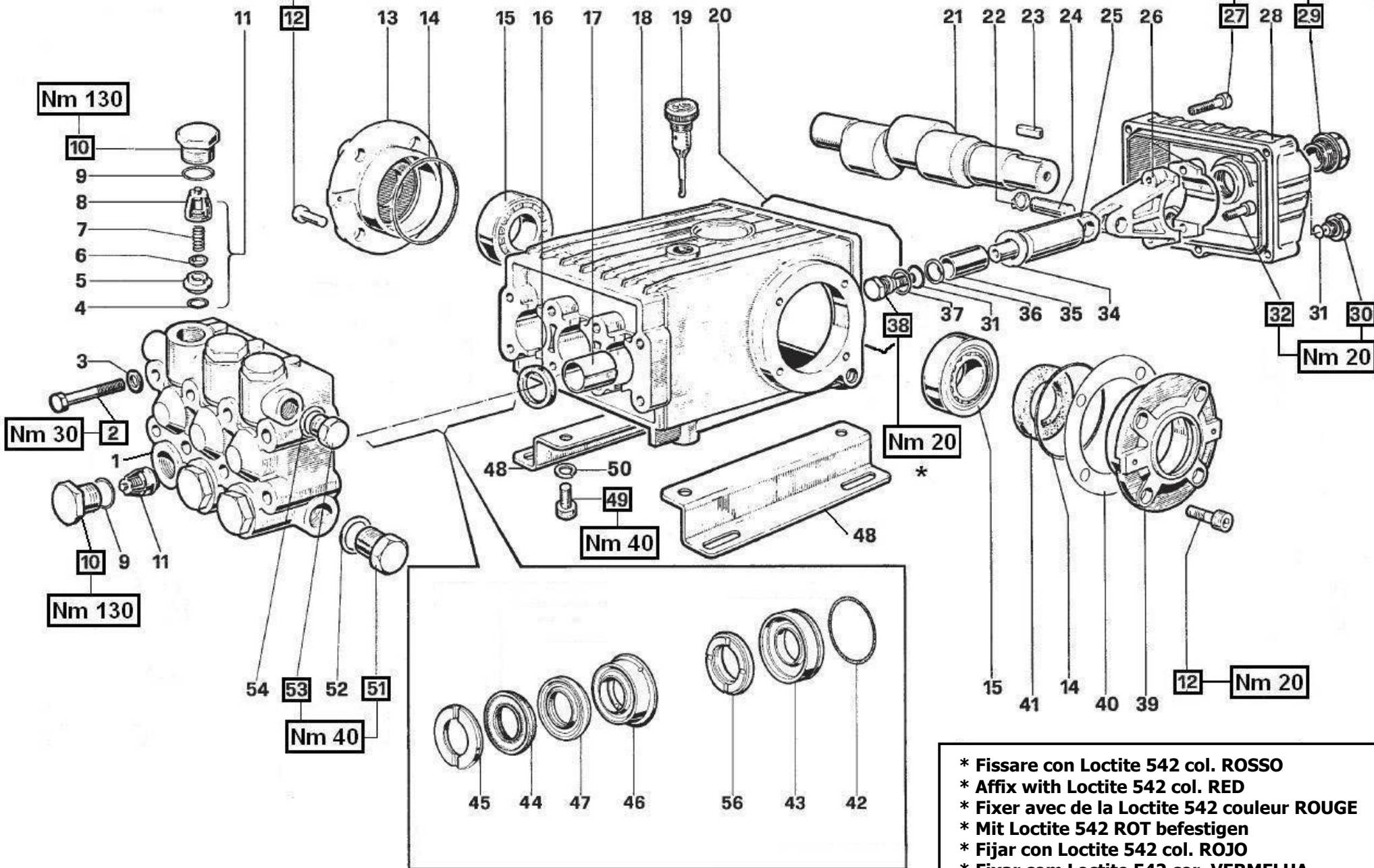

\* Fissare con Loctite 542 col. ROSSO  
 \* Affix with Loctite 542 col. RED  
 \* Fixer avec de la Loctite 542 couleur ROUGE  
 \* Mit Loctite 542 ROT befestigen  
 \* Fijar con Loctite 542 col. ROJO  
 \* Fixar com Loctite 542 cor. VERMELHA

77



**WS82 - WS101 - WS133  
W912 - W913 - WS102  
WS131 - WS151  
WS171 - WS201 - W916  
WS152 - WS202 - W921  
W914 - W922**

<b>OTTONE BRASS</b>	<b>WS82 - WS101 - WS133 W912 - W913 - WS102 WS131 - WS151 - WS171 W914</b>
<b>NICKEL</b>	<b>WS201 - W916 - WS152 WS202 - W921 - W922</b>

**KIT RICAMBI – SPARE KITS**

KIT Nr.	KIT 1	KIT 2	KIT 3	KIT 6	OTTONE BRASS	NICKEL	KIT 7	KIT 10	KIT 28	KIT 69	KIT 71
					KIT 4	KIT 5					
<b>Posizioni includi Positions included</b>	<b>4-5 6-7 8 (11)</b>	<b>16</b>	<b>41</b>	<b>31-34 36-37 38</b>	<b>9-10</b>	<b>9-10</b>	<b>45</b>	<b>42-43</b>	<b>42-43 44-45 46-47 56</b>	<b>44-47 56</b>	<b>46-47</b>
<b>Nr. Pcs.</b>	<b>6</b>	<b>3</b>	<b>2</b>	<b>3</b>	<b>6</b>	<b>6</b>	<b>6</b>	<b>3</b>	<b>1</b>	<b>3</b>	<b>3</b>

POS	COD.	DESCRIZIONE – DESCRIPTION - KIT	NR
1	47.1201.41 47.1202.41	Testata Ø 20 Testata Ø 20 – NICKEL	1 1
2	99.3206.00	Vite M8x70 UNI 5737	8
3	96.7020.00	Rosetta Ø 8 UNI 1736	8
4	90.3841.00	OR Ø 17.13x2.62 (3068)	1 6
5	36.2003.66	Sede valvola	1 6
6	36.2001.76	Valvola	1 6
7	94.7376.00	Molla Ø 9.4x14.8	1 6
8	36.2002.51	Guida valvola	1 6
9	90.3847.00	OR Ø 20.24x2.62 (3081)	4-5 6
10	98.2220.00 98.2222.00	Tappo M24x2x16.5 Tappo M24x2x16.5 - NICKEL	4 6 5 6
11	36.7032.01	Gruppo valvola	1 6
12	99.3039.00	Vite M8x16 UNI 5931	8
13	47.1511.22	Coperchio cuscinetto	1
14	90.3913.00	OR Ø 67.95x2.62 (3325)	2
15	91.8375.00 91.8377.00	Cuscinetto 32206 Cuscinetto 32206 - WS152-WS202-W921	2 2
16	90.1625.00	Anello rad. Ø 22x32x2.5	2 3
17	90.9126.00	Boccola Ø 22x25x30	3
18	47.0100.22 47.0102.22	Carter Carter - WS152-WS202-W921	1 1
19	98.2106.00	Tappo carico olio G 3/8"	1

POS	COD.	DESCRIZIONE – DESCRIPTION - KIT	NR
20	90.3922.00	OR Ø 133.02x2.62 (3525)	1
21	47.0204.35 47.0206.35 47.0210.35 47.0215.35 47.0217.35 47.0218.35 47.0219.35 47.0230.35	Albero - WS102 Albero - WS151-WS201-W916-W914-W922 Albero - WS131 Albero - WS171 Albero - WS82-WS152-WS202 Albero - WS101-W912 Albero - WS133-W913-W921 Albero - W914-W922	1 1 1 1 1 1 1 1
22	90.0557.00	Anello di fermo Ø 12	6
23	91.4890.00	Linguetta 8x7x35 UNI 6604	1
24	97.7380.00	Spinotto Ø 13x35	3
25	47.0503.56 47.0504.66 47.0505.54	Guida pistone - WS201-W916-WS152-W922 WS202-W921 Guida pistone - WS82-WS101-WS133-W912 W913 Guida pistone - WS102-WS131-WS151 WS171-W914	3 3 3
26	47.0300.01	Biella completa	3
27	99.1837.00 99.1912.00	Vite M6x14 UNI 5931 - WS82-WS101 WS133-W912-W913 Vite M6x30 UNI 5931 - WS102-WS131 WS151-WS171-WS201-W916-WS152-WS202 W921-W914-W922	5 5
28	47.1600.22 47.1601.22	Coperchio carter - WS82-WS101-WS133 W912-W913 Coperchio carter - WS102-WS131-WS151 WS171-WS201-W916-WS152-WS202-W921 W914-W922	1 1
29	97.5968.00	Spia livello olio G 3/4"	1
30	98.2042.50	Tappo G 1/4"x9 TE – Zinc.	1
31	90.3585.00	OR Ø 10.82x1.78 (2043)	6 4
32	99.3099.00	Vite M8x35 UNI 5931	6

POS	COD.	DESCRIZIONE – DESCRIPTION - KIT	NR
34	96.7286.00	Rosetta Ø 14x28x0.5	3
35	47.0404.09	Pistone Ø 20	3
36	90.5067.00	Anello antiest. Ø 11x14x1.5	6 3
37	96.7280.00	Rosetta Ø 14x18.5x0.5	6 3
38	47.2195.66	Vite fissaggio pistone	6 3
39	47.1510.22	Coperchio cuscinetto	1
40	97.5678.00	Spessore	2
41	90.1648.00	Anello rad. Ø 30x55x7	3 1
42	90.3616.00	OR Ø 34.65x1.78 (2137)	10-28 3
43	47.0805.70	Anello di fondo Ø 20	10-28 3
44	90.2705.00	Anello tenuta Ø 20 H.P.	28-69 3
45	47.1000.51	Anello di testa Ø 20	7-28 3
46	47.2169.70	Anello intermedio Ø 20	28-71 3
47	90.2704.00	Anello RESTOP Ø 20	28-69-71 3
48	47.2000.74	Piedino	2
49	99.3644.00	Vite M10x18 UNI 5931	4
50	96.7106.00	Rosetta Ø 10 DIN 7980	4
51	98.2176.00	Tappo G 1/2"x10	1
52	96.7514.00	Rosetta Ø 21.5x27x1.5	1
53	98.2100.00	Tappo G 3/8"x13	1
54	96.7380.00	Rosetta Ø 17.5x23x1.5	1
56	90.2710.00	Anello tenuta Ø 20 L.P.	28-69 3

78